

# SHIP 150 cm

**BATHTUB IN NOVOTECH - INSIDE WHITE MATT, OUTSIDE CUSTOMISABLE.  
UNIT COMBINED WITH TOP IN OCRITECH WHITE AND CUSTOMISABLE COLOUR.**

Dimensions		Capacity	Furniture installation	Code	External bathtub finish	Furniture finish						
Cm	H	lt.			Matt White	Colour choice	Matt White	White wood	Grain	Burlington	Wenge	Colour choice
<b>STANDARD</b>												
150 x 70	62	265	-	<b>SHI115070-</b>	U	◆	U	I	M	N	V	◆
<b>STANDARD - FURNITURE WITH MIXER</b>												
150 x 70	62	265	freestanding	<b>SHI1150702CS-</b>	U	◆	U	I	M	N	V	◆
150 x 70	62	265	centre of wall	<b>SHI1150702CP-</b>								
150 x 70	62	265	right corner	<b>SHI1150702AD-</b>								
150 x 70	62	265	left corner	<b>SHI1150702AS-</b>								
<b>NATURAL AIR - FURNITURE WITH MIXER- FURNITURE WITH UNIT AND MIXER</b>												
150 x 70	62	265	freestanding	<b>SHIN1507002CS-</b>	U	◆	U	I	M	N	V	◆
150 x 70	62	265	centre of wall	<b>SHIN1507002CP-</b>								
150 x 70	62	265	right corner	<b>SHIN1507002AD-</b>								
150 x 70	62	265	left corner	<b>SHIN1507002AS-</b>								

OPTIONAL: EXTERNAL LED LIGHT AND FLOOR-STANDING TAP, SEE PAGE 456

◆ COLOUR CHOICE										
<b>19</b>	<b>FB</b>	<b>FC</b>	<b>FD</b>	<b>F8</b>	<b>F9</b>	<b>FA</b>				
Black	Terra	luta	Perla	Artico	Fucile	Cortecchia				
SPECIAL COLOURS ON REQUEST										
<b>F1</b>	<b>F2</b>	<b>F5</b>	<b>F6</b>	<b>F7</b>	<b>FG</b>	<b>FK</b>	<b>FL</b>	<b>XZ</b>	<b>FM</b>	<b>FN</b>
Aragosta	Rubino	Senape	Lime	Turchino	Beige	Corda	Grey	Bright Blu	Light Grey	Tortora

FREESTANDING



FREESTANDING / CENTRE OF WALL WITH CENTRAL UNIT, TAPS AND FITTINGS



LEFT CORNER WITH UNIT, TAPS AND FITTINGS



RIGHT CORNER WITH UNIT, TAPS AND FITTINGS





**BATHTUB UNIT: TECHNOLOGY AND AESTHETIC APPEAL**

The unit is the ideal practical addition to the bathtub. Fitted with a simple and functional tap design, it houses all the technological elements. A variety of finishes can be chosen or colour to match the bathtub.

**DESIGN AND TECHNOLOGY - NATURAL AIR**

Lie back and let the micro bubbles envelop and silently caress your body, oxygenating your skin. The pleasure of a massage, immersed in a beautifully designed bathtub. From the taps to the bathtub unit, your new bathroom project is fully coordinated in terms of colour, shape and materials.

**FUNCTIONS AND FEATURES**

(available according to the equipment)



Natural air



Internal white Led light



Taps and fittings on side of bathtub



Drainage system with click-clack plug.

**BATHTUB WITH INTEGRATED OVERFLOW COMPLIANT WITH CURRENT REGULATIONS**

# SHIP 160 cm

**BATHTUB IN NOVOTECH - INSIDE WHITE MATT, OUTSIDE CUSTOMISABLE.  
UNIT COMBINED WITH TOP IN OCRITECH WHITE AND CUSTOMISABLE COLOUR.**

Dimensions	Capacity	Furniture installation	Code	External bathtub finish		Furniture finish						
						w	Wood finish					
Cm	H	lt.		Matt White	Colour choice	Matt White	White wood	Grain	Burlington	Wenge	Colour choice	
<b>STANDARD</b>												
160 x 70	62	280	-	<b>SHI116070-</b>	U	◆	U	I	M	N	V	◆
<b>STANDARD - FURNITURE WITH MIXER</b>												
160 x 70	62	280	freestanding	<b>SHI1160702CS-</b>	U	◆	U	I	M	N	V	◆
160 x 70	62	280	centre of wall	<b>SHI1160702CP-</b>								
160 x 70	62	280	right corner	<b>SHI1160702AD-</b>								
160 x 70	62	280	left corner	<b>SHI1160702AS-</b>								
<b>NATURAL AIR - FURNITURE WITH MIXER- FURNITURE WITH UNIT AND MIXER</b>												
160 x 70	62	280	freestanding	<b>SHIN1607002CS-</b>	U	◆	U	I	M	N	V	◆
160 x 70	62	280	centre of wall	<b>SHIN1607002CP-</b>								
160 x 70	62	280	right corner	<b>SHIN1607002AD-</b>								
160 x 70	62	280	left corner	<b>SHIN1607002AS-</b>								

OPTIONAL: EXTERNAL LED LIGHT AND FLOOR-STANDING TAP, SEE PAGE 456

◆ COLOUR CHOICE										
<b>19</b>	<b>FB</b>	<b>FC</b>	<b>FD</b>	<b>F8</b>	<b>F9</b>	<b>FA</b>				
Black	Terra	luta	Perla	Artico	Fucile	Corteccia				
SPECIAL COLOURS ON REQUEST										
<b>F1</b>	<b>F2</b>	<b>F5</b>	<b>F6</b>	<b>F7</b>	<b>FG</b>	<b>FK</b>	<b>FL</b>	<b>XZ</b>	<b>FM</b>	<b>FN</b>
Aragosta	Rubino	Senape	Lime	Turchino	Beige	Corda	Grey	Bright Blu	Light Grey	Tortora

FREESTANDING



FREESTANDING / CENTRE OF WALL WITH CENTRAL UNIT, TAPS AND FITTINGS



LEFT CORNER WITH UNIT, TAPS AND FITTINGS



RIGHT CORNER WITH UNIT, TAPS AND FITTINGS







◀ FLOOR-STANDING TAP

Finish	Code	Price
Chrome	<b>RUBPVASRSN-K</b>	
Matt Black	<b>RUBPVASRSN-H</b>	



◀ LOWER PERIMETER LED KIT FOR INFINITIVE BATHTUB

Code	Price
<b>KLINF</b>	



◀ LOWER PERIMETER LED KIT FOR SHIP BATHTUB

Dimensions (cm)	Code	Price
150	<b>KLSHI150</b>	
160	<b>KLSHI160</b>	

◀ TAPS AND FITTINGS ON SIDE OF BATHTUB FOR UNIT

Finish	Code	Price
Matt Black	<b>RUBBVASRSN-H</b>	



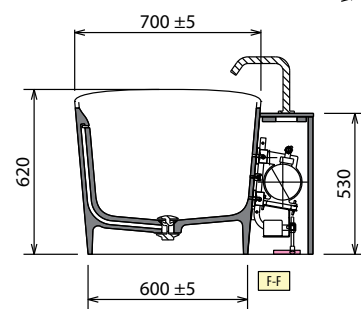
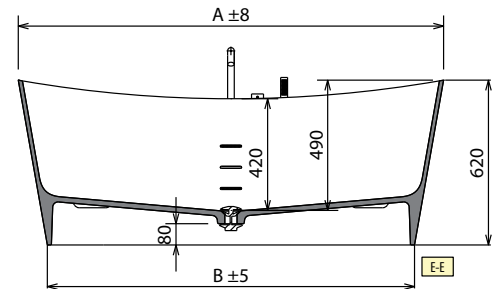
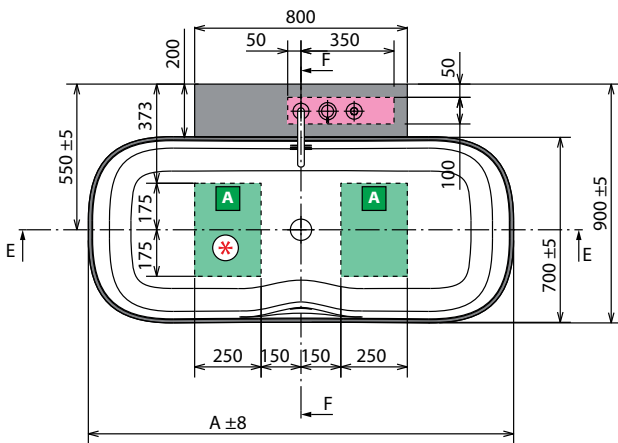
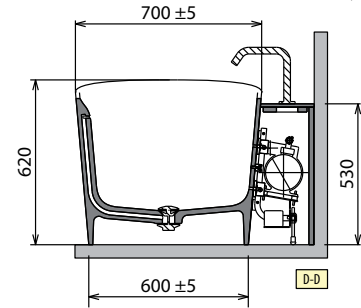
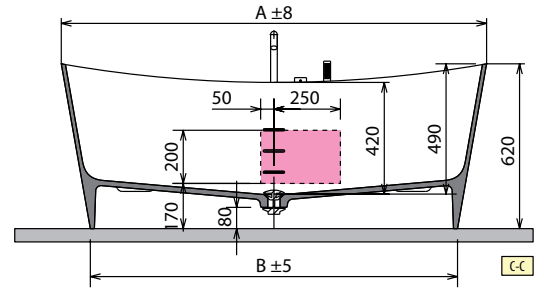
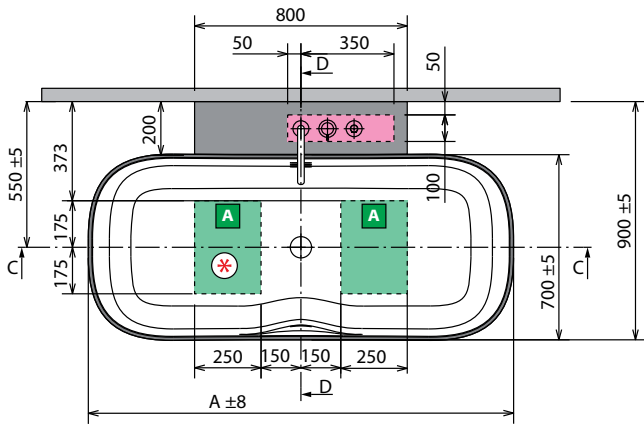

Model	A	B	C	D	Weight	Capacity litres
<b>Ship 150</b>	1500 mm	1280 mm	900 mm	1650 mm	105 kg	260 lt
<b>Ship 160</b>	1600 mm	1380 mm	950 mm	1750 mm	115 kg	290 lt

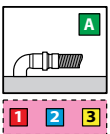

### HYDRAULIC CHARACTERISTIC

1 Natural Air jets  
Siphon connection 40 mm

### ELECTRICAL CHARACTERISTIC

Tension: 220-230 V  
Frequency: 50 Hz  
Maximum power consumption:  
Natural Air: 1050 W

Install a 30mA differential switch upstream of the appliance with a multiple-pole switch with a minimum contact opening  $\geq 3$  mm.